

REV	DATE	DESCRIPTION	APP

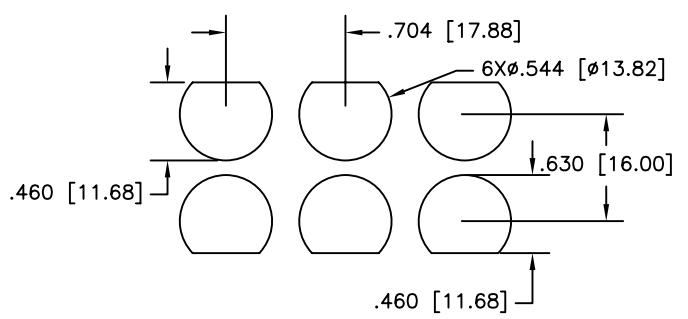

PANEL CUTOUT

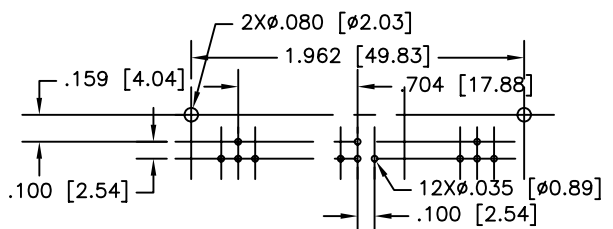
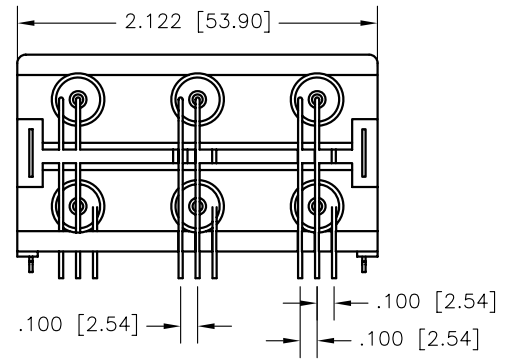
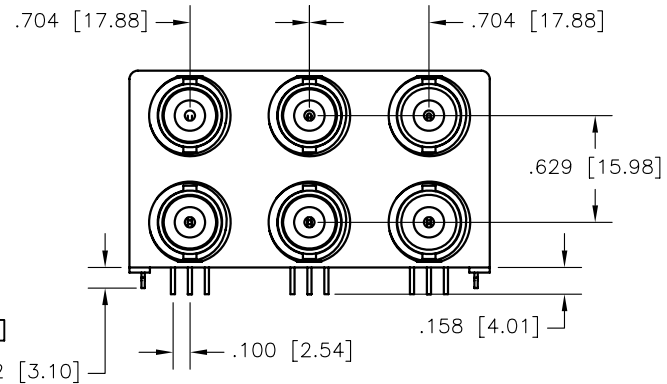
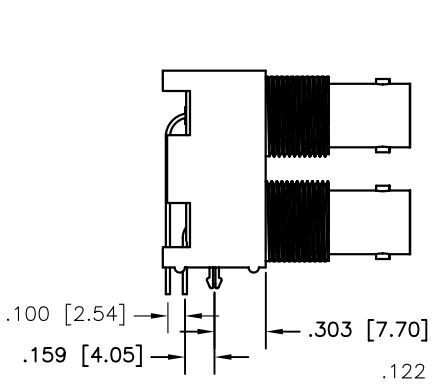
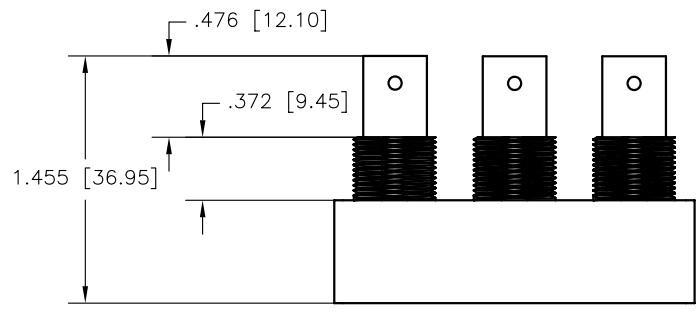

P.C.B. LAYOUT

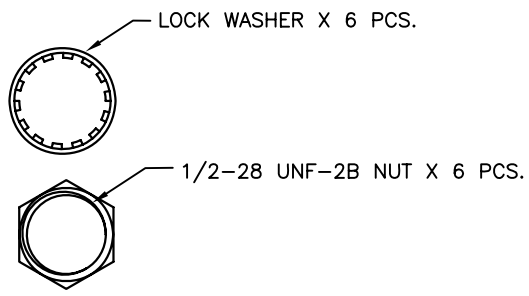
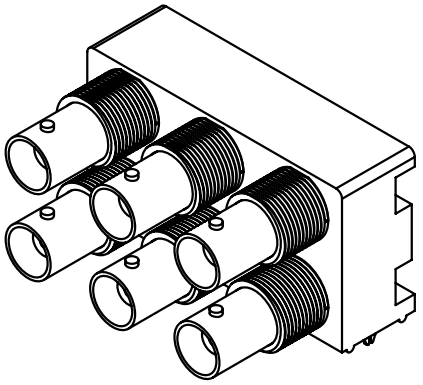

THIS IS A CONTROLLED DOCUMENT AND IS SUBJECT TO CHANGE. CONTACT NORTHERN TECHNOLOGIES ENGINEERING FOR THE LATEST REVISION.

UNLESS OTHERWISE SPECIFIED	SIGNATURES	DATE	Northern Technologies			
1. DIMENSIONS IN INCHES [MM] 2. TOLERANCE UNLESS OTHERWISE SPECIFIED .XXX ± .005 [0.127] .XX ± .02 [0.508] .X ± .03 [0.762] FRACT. ± 1/32 ANGULAR ± 1/2°	DRAWN JSD	15-FEB-09	PART NUMBER SEE PART NUMBER INFORMATION DESCRIPTION BNC R/A 6 PORT PCB MOUNT			
	CHECKED SCN	15-FEB-09				
	ISSUED		20-FEB-09	SHEET 1	CODE 200_246	DWG NO. 0002-200-246
	SCALE N.T.S.			SHEET 1 OF 2		

THIS DRAWING IS THE PROPERTY OF NORTHERN TECHNOLOGIES AND SHOULD NOT BE REPRODUCED WITHOUT NORTHERN TECHNOLOGIES WRITTEN PERMISSION.

REV	DATE	DESCRIPTION	APP

**BNC SPECIFICATIONS**

**Electrical:**

1. Impedence: See Part Number Information
2. Frequency Range: 0 ~ 1 GHz
3. Voltage Rating: 500 volts rms
4. Dielectric Withstanding Voltage: 1500 volts rms
5. Contact Resistance: 3.0 Milliohms Max. (Contact Area)
6. Insulation Resistance: 5000 Megohms Min.

**Mechanical:**

1. Mating Cycles: 500 min.

**Material:**

1. Body: PBT+30%G.F.
2. Outer Shell: Zinc Alloy – Nickel Plated
3. Center Contact: Phosphor Bronze with Gold Plating at Contact Area, Tin Plating with Nickel Underplate over Tail.
4. Grounding Pin: Copper – Tin Plated
5. Insulator: Polypropylene UL 94HB
6. Mounting Posts: Brass – Tin Plated

**Environmental:**

1. Operating Temperature Range: -65°C to +165°C
2. Thermal Shock: MIL-STD-202 method 107, test condition B
3. Physical Shock: MIL-STD-202 method 204, test condition B

**PART NUMBER INFORMATION**

PART NUMBER	HOUSING	IMPEDENCE
RBNCRHD6E5W0000ZZ	WHITE	50 ohms
RBNCRHD6E7W0000ZZ	WHITE	75 ohms

UNLESS OTHERWISE SPECIFIED	SIGNATURES	DATE	<b>Northern Technologies</b> <small>THIS DRAWING IS THE PROPERTY OF NORTHERN TECHNOLOGIES AND SHOULD NOT BE REPRODUCED WITHOUT NORTHERN TECHNOLOGIES WRITTEN PERMISSION.</small>		
1. DIMENSIONS IN INCHES [MM] 2. TOLERANCE UNLESS OTHERWISE SPECIFIED .XXX ± .005 [0.127] .XX ± .02 [0.508] .X ± .03 [0.762] FRACT. ± 1/32 ANGULAR ± 1/2°	DRAWN JSD	15-FEB-09	PART NUMBER SEE PART NUMBER INFORMATION DESCRIPTION BNC R/A 6 PORT PCB MOUNT		
	CHECKED SCN	15-FEB-09			
	ISSUED	20-FEB-09	SHEET 1	CODE 200-246	DWG NO. 0002-200-246
	ENG		SCALE N.T.S.	SHEET 2 OF 2	

THIS IS A CONTROLLED DOCUMENT AND IS SUBJECT TO CHANGE. CONTACT NORTHERN TECHNOLOGIES ENGINEERING FOR THE LATEST REVISION.