

REVISIONS

ZONE	REV	DESCRIPTION	DATE	APPROVED
	A	ECN 0619	25-AUG-06	
	B	ECN 0694	31-MAY-11	
	C	ECN 0707	11-SEP-12	

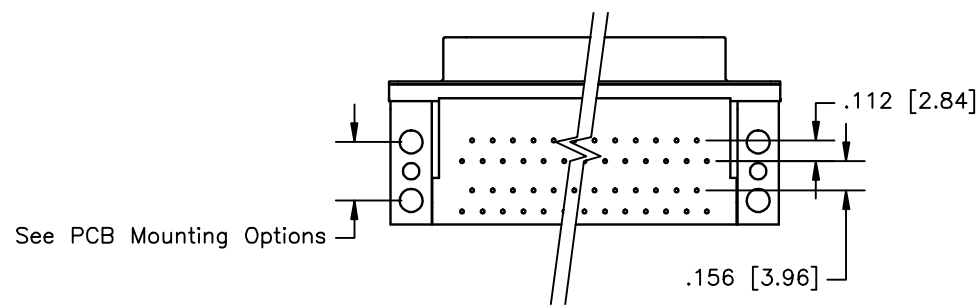
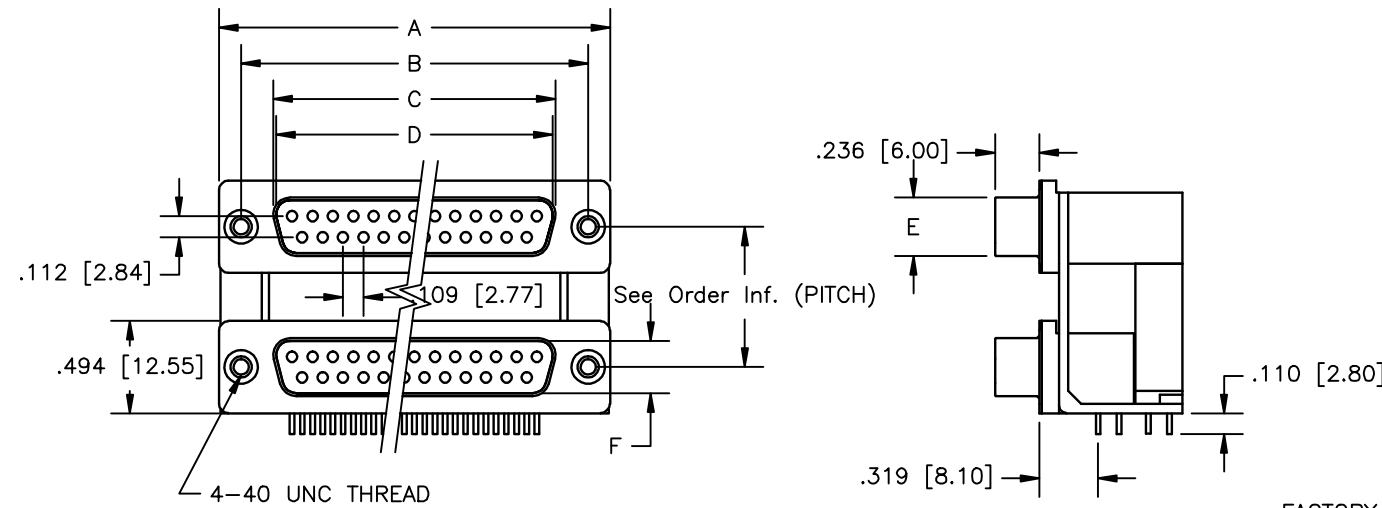

DUL SERIES CONNECTORS — DIMENSIONS —		INCHES [MM]				
No. of Contacts	A	B	C	D	E Max. Female	F Min. Male
	± 0.010 [± 0.254]	± 0.010 [± 0.254]	± 0.010 [± 0.254]	± 0.010 [± 0.254]	± 0.010 [± 0.254]	± 0.010 [± 0.254]
9	1.213 [30.81]	0.984 [25.00]	0.643 [16.30]	0.666 [16.92]	0.311 [7.90]	0.326 [8.30]
15	1.543 [39.20]	1.311 [33.30]	0.968 [24.60]	0.994 [25.25]	0.311 [7.90]	0.326 [8.30]
25	2.090 [53.10]	1.854 [47.10]	1.508 [38.30]	1.534 [38.96]	0.311 [7.90]	0.326 [8.30]

ORDER INFORMATION

FACTORY DESIGNATOR
LEAVE BLANK ()

DUL E 25S25S B 2 S S
 SERIES _____
 RoHS _____
 TOP TO BOTTOM
 NO. OF CONTACTS
 9, 15, 25
 CONTACT TYPE
 PP - Male-Male _____
 SS - Female-Female _____
 PS - Male-Female _____
 SP - Female-Male _____

CONTACT FINISH

S: GOLD FLASH OVER NICKEL ON CONTACT AREA,
TIN PLATE ON SOLDER TAILS.

BLANK: GOLD FLASH OVER NICKEL ON CONTACT AREA
NICKEL PLATE ON SOLDER TAILS.

FRONT MOUNTING OPTIONS

S: 4-40 FEMALE SCREWLOCKS 0.189 [4.80]
S1: 4-40 FEMALE SCREWLOCKS 0.228 [5.80]

CONSULT FACTORY FOR OTHER MOUNTING OPTIONS

PCB MOUNTING OPTIONS

2: LOCKING FORKS (DUAL) 0.272 [6.90] CENTRELINE
2A: LOCKING FORKS (DUAL) 0.311 [7.90] CENTRELINE
CONSULT FACTORY FOR OTHER PCB MOUNTING OPTIONS

PITCH:

A: 0.625 [15.88]
B: 0.750 [19.05]
C: 0.900 [22.86]

NOTES:

- SHELL MATERIAL: STEEL
- SHELL FINISH: TIN PLATED
- INSULATOR MATERIAL: THERMOPLASTIC UL94V-0
- INSULATOR COLOR: BLACK
- CONTACT MATERIAL: STAMPED - COPPER ALLOY
- CONTACT FINISH: SEE ORDER INFORMATION
- TEMPERATURE RANGE: -55° TO +105° CENTIGRADE
- VOLTAGE RATING: 250 VAC
- CURRENT RATING: 3 AMPS MAX.
- INSULATION RESISTANCE: 3000 MEGOHMS @ 500 VDC
- CONTACT RESISTANCE: 25 MILLIOHMS MAX.
- DIELECTRIC WITHSTANDING VOLTAGE: 1000 VAC MINIMUM (1 MINUTE)

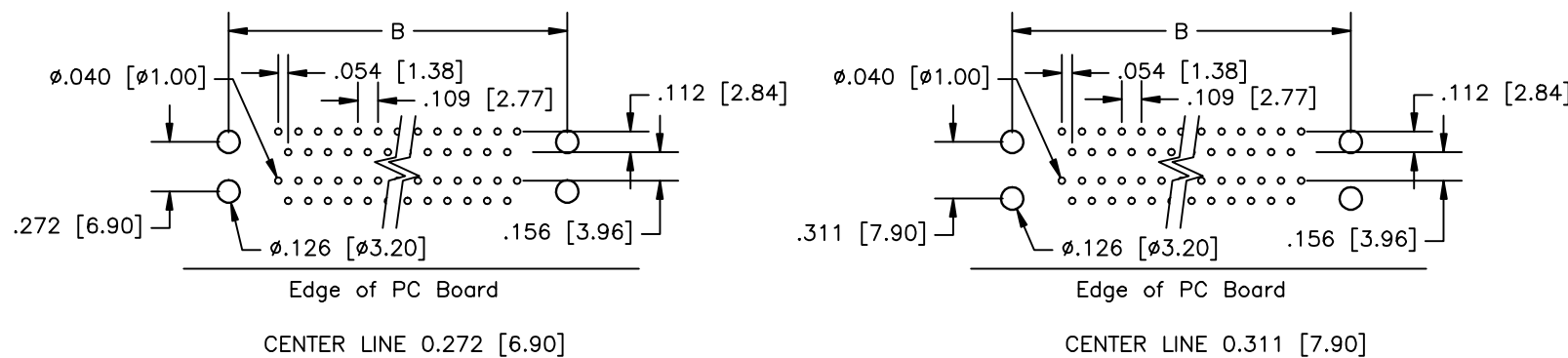

P. C. B. LAYOUT PATTERN

THIS IS A CONTROLLED DOCUMENT AND IS
SUBJECT TO CHANGE. CONTACT NORTHERN
TECHNOLOGIES ENGINEERING FOR THE
LATEST REVISION.

UNLESS OTHERWISE SPECIFIED	SIGNATURES	DATE	Northern Technologies	
1. ALL DIMENSIONS ARE IN INCHES (MM) 2. DIMENSIONS ARE TYPICAL	DRAWN JSD	19-JUL-06	THIS DRAWING IS THE PROPERTY OF NORTHERN TECHNOLOGIES AND SHOULD NOT BE REPRODUCED WITHOUT NORTHERN TECHNOLOGIES WRITTEN PERMISSION.	
	CHECKED SCN	19-JUL-06	PART NUMBER SEE ORDER INFORMATION	
	ENG		DESCRIPTION DULE SERIES - DUAL PORT CONNECTORS	
	ISSUED	19-JUL-06	SHEET 1	CODE 200_186
			SCALE N.T.S.	SHEET 1 OF 1